

SPECIFICATIONS

1. ENVIRONMENT SPECIFICATIONS

- WORKING TEMPERATURE: -30°C TO 105°C
- PROTECTION CLASS: IP65

2. ELECTRICAL SPECIFICATIONS

- WORKING VOLTAGE: 5.0 - 16.0vdc
- TOTAL RESISTANCE: $2K\Omega \pm 20\%P$
- INSULATING RESISTANCE: $\geq 10M\Omega$
- ELECTRICAL ANGLE: $300^\circ \pm 2^\circ$
- LINEARITY: $\pm 2\%$
- OUTPUT SMOOTHNESS: $< 0.5\%$
- REPEATABILITY: $\leq 0.1\%$
- WIPER WORKING CURRENT: $\leq 1\mu A$
- MAXIMUM WIPER WORKING CURRENT: 10mA

3. MECHANICAL SPECIFICATIONS

- TRAVEL: 360°
- LIFE: 3,000,000 CYCLES
- WEIGHT: 29g

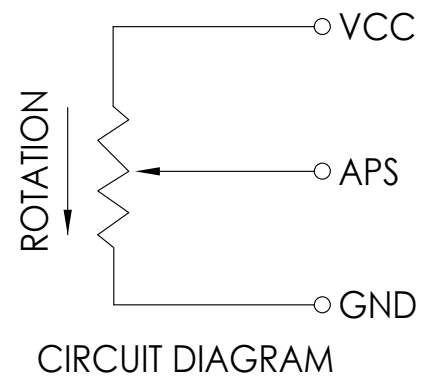
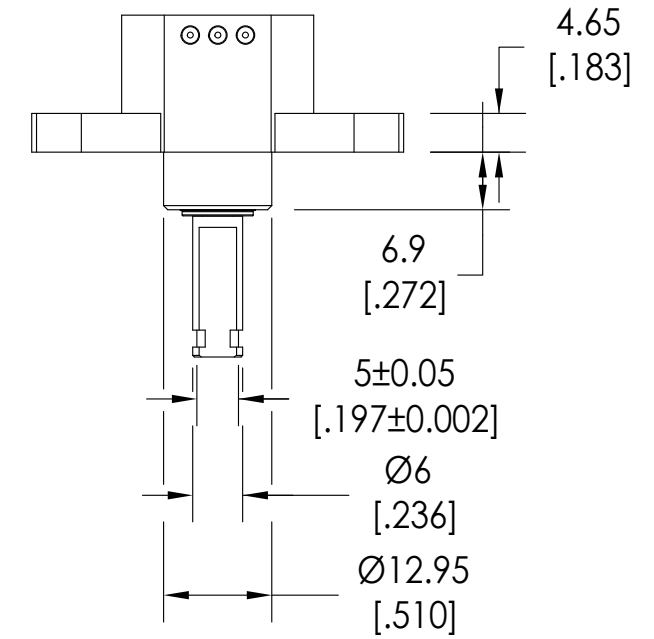
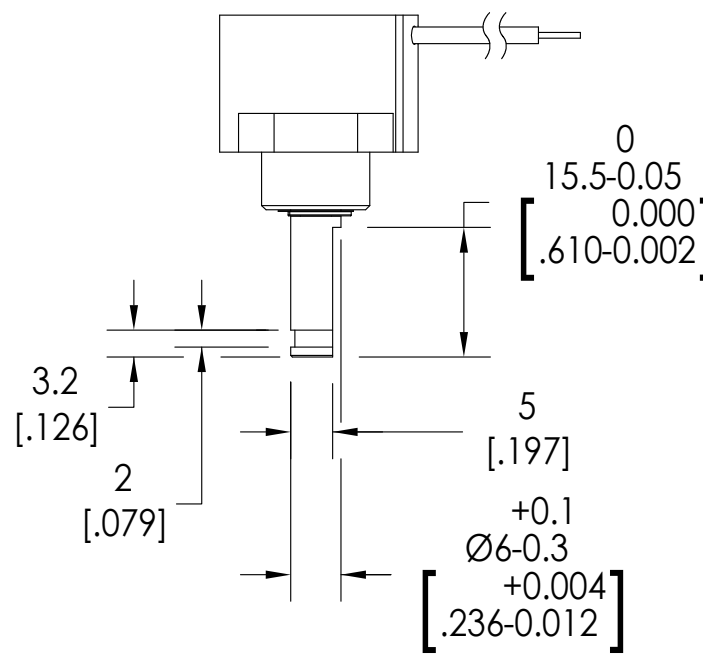

WIRE	FUNCTION
BLK	VCC
GRN	APS
RED	GND

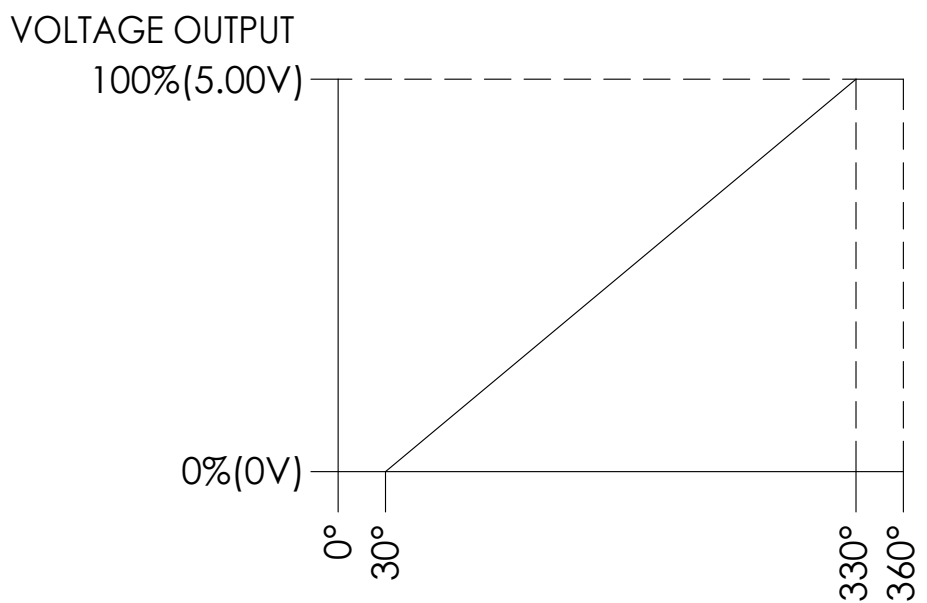
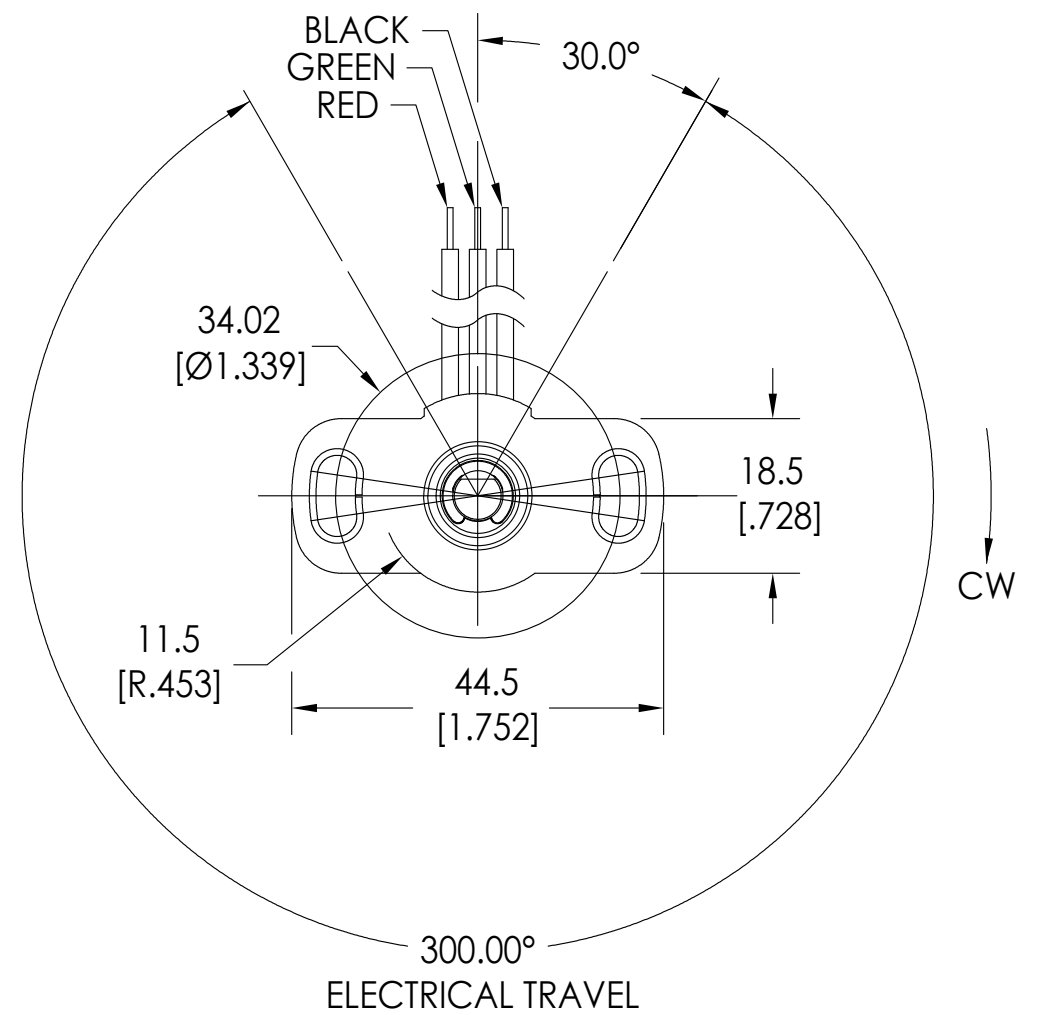

SENSOR ELECTRICAL OUTPUT
FIGURE A

UNITS IN millimeter [inch]

PART #
5114